

NO.	DESCRIPTION	DATE	BY
01	TO VITA BUILDERS FOR REVIEW & COMMENT	07/10/07	JFH
02	BUCKET ELEVATOR REVISIONS TO TUNNEL	08/01/07	JFH
03	REVISIONS PER VITA BUILDERS MEMO OF 08/03/07	08/05/07	JFH
04	REVISIONS PER VITA BUILDERS MEMO OF 08/07/07	08/08/07	JFH
05	REVISIONS PER REQ. OF CANADIAN NATIONAL RR	08/15/07	JFH
06	SUBMITTED FOR CANADIAN NATIONAL RR REVIEW	08/21/07	JFH
07	FOR CONSTRUCTION - EXCEPT @ RR CROSSING	09/06/07	JFH
08	REVISIONS REQUESTED BY CANADIAN NATIONAL RR	10/06/07	JFH

STRUCTURAL NOTES

GENERAL NOTES:

1. THE ICC 2003 INTERNATIONAL BUILDING CODE (IBC 2003) WITH THE STATE OF WISCONSIN AMENDMENTS FORMS THE BASIS FOR THE STRUCTURAL DESIGN.
2. THE ENGINEER IS NOT RESPONSIBLE FOR CONSTRUCTION MEANS OR METHODS OR FOR SUPERVISION OF CONSTRUCTION.
3. ALL DIMENSIONS ARE TO BE CROSS CHECKED WITH EXISTING FIELD DIMENSIONS AND APPROVED SHOP DRAWINGS FOR THE VARIOUS MATERIALS AND BUILDING COMPONENTS. ALL DIMENSIONAL DISCREPANCIES ARE TO BE BROUGHT TO THE ATTENTION OF THE ENGINEER.
4. THE CONTRACTOR IS TO COMPLY WITH THE REQUIREMENTS OF THE CANADIAN NATIONAL RAILROAD WHILE WORKING IN AND AROUND THE RAILROAD RIGHT-OF-WAY.
5. ALL WORK IS TO BE PERFORMED IN A SAFE AND WORKMAN LIKE MANNER IN COMPLIANCE WITH THE FEDERAL OCCUPATIONAL HEALTH AND SAFETY ACT (OSHA) AND ALL STATE OF WISCONSIN BUILDING CODES AND ZONING ORDINANCES AS THEY MAY PERTAIN TO THIS PROJECT.

FOUNDATIONS:

1. THE CONTRACTOR IS TO VERIFY ALL CONDITIONS AT THE SITE, PARTICULARLY THE LOCATION OF ANY UNDERGROUND UTILITIES BEFORE EXCAVATION. ANY DISCREPANCIES ARE TO BE BROUGHT TO THE ATTENTION OF THE ENGINEER.
2. ALL FOUNDATIONS SHALL BEAR ON FIRM, UNDISTURBED NATIVE SOIL OR ON ENGINEERED FILL. IN BOTH INSTANCES THE FOOTING SUBGRADE SHALL BE COMPACTED TO A MINIMUM OF 95% OF THE ASTM 698 MAXIMUM DENSITY AT OPTIMUM MOISTURE CONTENT (+2%) PRIOR TO POURING CONCRETE.
3. NO FOUNDATIONS SHALL BE INSTALLED IN EXCAVATIONS CONTAINING WATER, UNSATURABLE SOIL OR FROZEN GROUND. SUCH CONDITIONS SHALL BE BROUGHT TO THE ATTENTION OF THE ENGINEER.
4. THE CONTRACTOR SHALL NOTIFY THE APPROPRIATE BUILDING INSPECTOR AND THE CANADIAN NATIONAL RAILROAD A MINIMUM OF 24 HOURS BEFORE POURING FOUNDATION CONCRETE TO ALLOW THEIR INSPECTION.

CONCRETE:

1. ALL CONCRETE MATERIALS AND WORKMANSHIP SHALL CONFORM TO THE AMERICAN CONCRETE INSTITUTE'S BUILDING CODE REQUIREMENTS FOR REINFORCED CONCRETE, ACI 318-02.
2. CONCRETE SHALL HAVE A MINIMUM CEMENT CONTENT OF 5 BAGS OF CEMENT PER CUBIC YARD AND SHALL DEVELOP A MINIMUM 28 DAY COMPRESSIVE STRENGTH OF 3,000 PSI. SUBMIT MIX DESIGNS AND TEST DATA FOR THE ENGINEER'S REVIEW AT LEAST SEVEN (7) DAYS PRIOR TO POURING CONCRETE.
3. THE CONTRACTOR SHALL FOLLOW THE REQUIREMENTS OF ACI 308R-99 HOT WEATHER CONCRETING, AND ACI 308R-88 COLD WEATHER CONCRETING, AS APPLICABLE TO WEATHER CONDITIONS DICTATE.
4. REINFORCING STEEL MATERIALS, BENDING AND PLACEMENT DETAILS SHALL CONFORM TO THE MANUAL OF STANDARD PRACTICE FOR DETAILS AND DETAILING OF CONCRETE REINFORCEMENT, ACI 315-02. MINIMUM COVER FOR FOUNDATION REINFORCING STEEL SHALL BE 3".

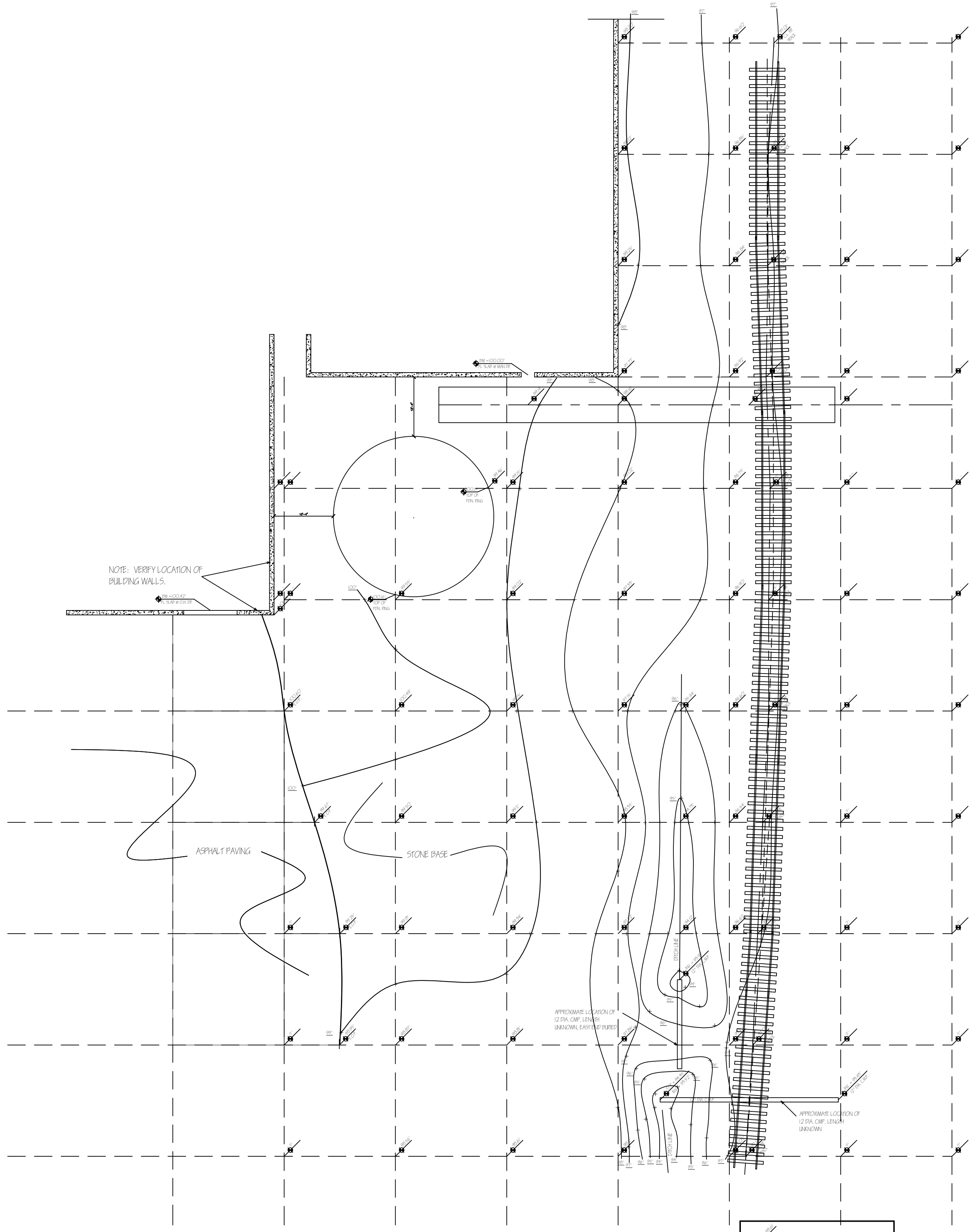

C-1 SITE & GRADING PLAN
SCALE: 1/16" = 1'-0"

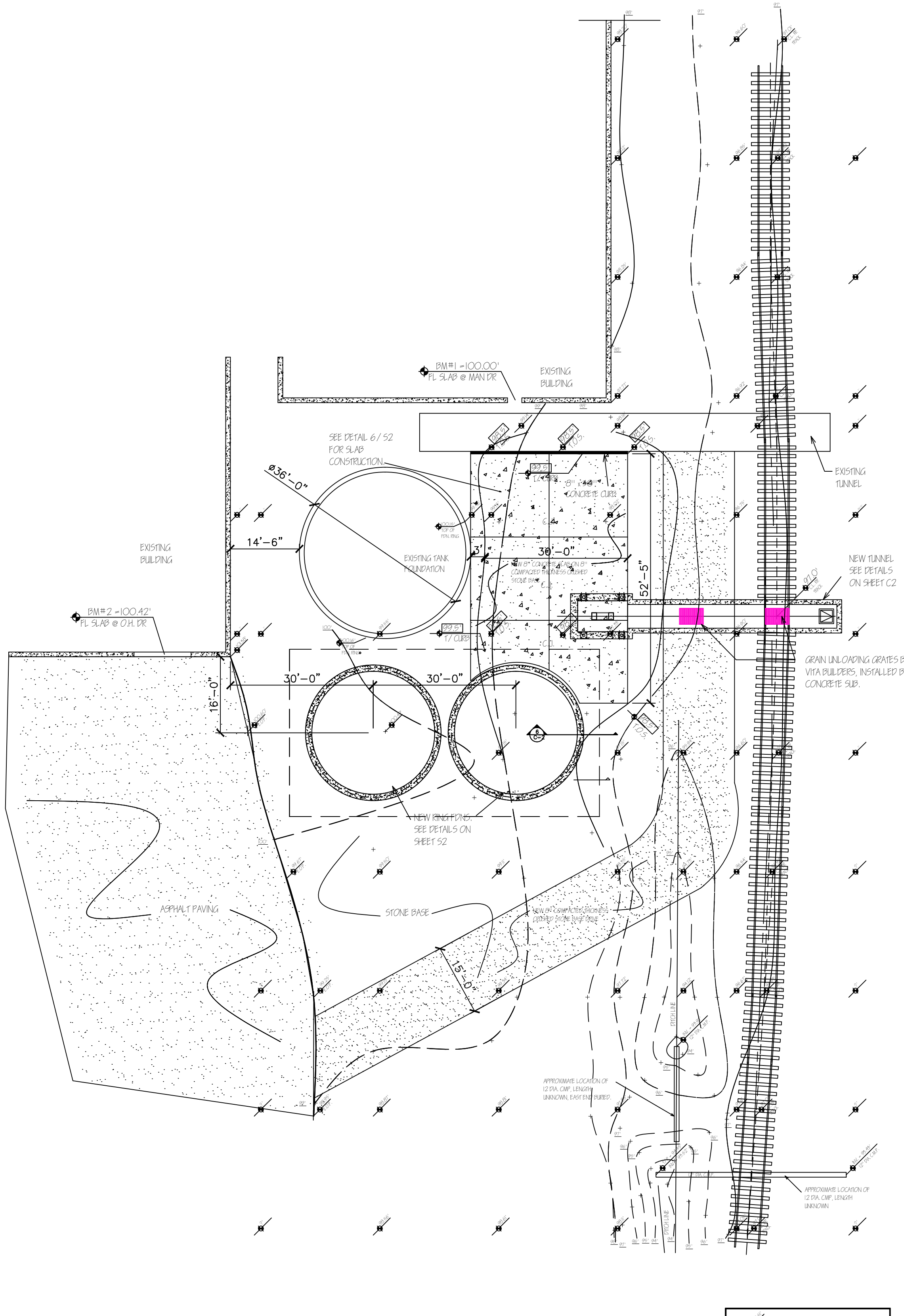

C-2 NEW GRADING & FDN. PLAN
SCALE: 1/16" = 1'-0"

PROJECT: CP FEEDS TANK FARM, VALDERS, WI
 FOR VITA BUILDERS, FALL RIVER, WI
 SHEET: SITE & GRADING PLAN

JAMES F. HEIDT, PE, LLC
 CIVIL & STRUCTURAL ENGINEERING
 2543 LAUNDLE DR. BEL OTE, WISCONSIN 53511
 PHONE: 608/368/3700 CELL: 608/331/7184 FAX: 608/368/3701 E-MAIL: JHEIDT@JHEIDT.COM

DRAWN: JFH
 DATE: 07/09/07
 APPROVED: _____
 RELEASED: _____
 SHEET NO.

SEAL: JAMES F. HEIDT, PE
 WI. REG.: 15489
 EXP. DATE: 07/32/08

C-1

All documents prepared or furnished by the Engineer are instruments of the Engineer's professional service prepared specifically for this project. Any reuse or modification of any such documents without the Engineer's written permission is prohibited. © 2005 James F. Heidt, PE, LLC